

# Hour meter

HK 48, HK 49



## Highlights

- price competitive meter
- excellent quality
- long lifetime
- all necessary approvals
- your branding available

## Applications

- control panels

Mechanical data		Electrical data	
Front dimension:	HK 48: 72 x 72 mm HK 49: 96 x 96 mm	Operating voltage	24, 48, 60, 110, 120, 220, 230, 240, 400 VAC ± 10%, 50 or 60 Hz
Display	AC: 5 integers, 2 decimals DC: 6 integers, 1 decimal AC indicator, without reset	Current consumption	6-30, 10-80, 110, 220 VDC ± 10% AC: max. 8 mA DC: max. 9 mA
Digit height	4 mm	Accuracy	AC: ± 0,02 % DC: ± 0,002 %
Digit color	integer: white on black decimal: 50 Hz – red on black 60 Hz – red on white	Connection	screw terminals
Counting range	AC: 99999,99 h, DC: 999999,9 h	Ambient conditions	
Reading accuracy	AC: 1/100 h (36 sec) DC: 1/10 h (6 min)	Operating temperature	AC: -25 <sup>o</sup> C .. +80 <sup>o</sup> C DC: -20 <sup>o</sup> C .. +70 <sup>o</sup> C
Weight	HK 48: 125 g HK 49: 172 g	Storage temperature	AC: -40 <sup>o</sup> C .. +80 <sup>o</sup> C DC: -20 <sup>o</sup> C .. +70 <sup>o</sup> C
Housing color	black	Relative humidity	max. 80% at +25 <sup>o</sup> C
Bezels	-	Protection	IP40 front IP00 terminals IP20 terminals with back cover
Mounting options	X – two fixing screws	Approvals	CE Mark UL E171200  RoHS compliant

Ordering						
HK 48, HK 49 . x x / x x x / x x						
Mounting	Front dimension	Front protection	Connection	Package	Voltage (specify)	Frequency
X – two fixing screws	3 – 72x72 mm 7 – 96x96 mm	1 – IP40	1 – screw terminal	P – single	24, 48, 60, 110, 120, 220, 230, 240, 400 VAC  6-30, 10-80, 110, 220 VDC	50 Hz 60 Hz

# Hour meter

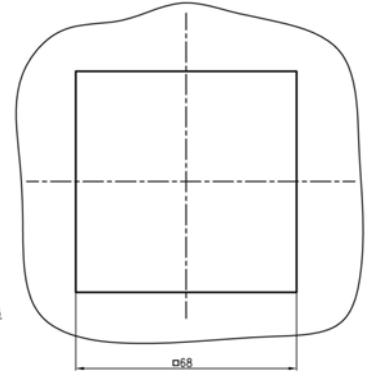
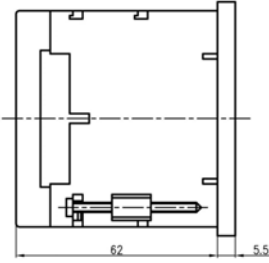
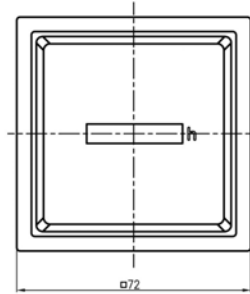

HK 48

Panel cut-out

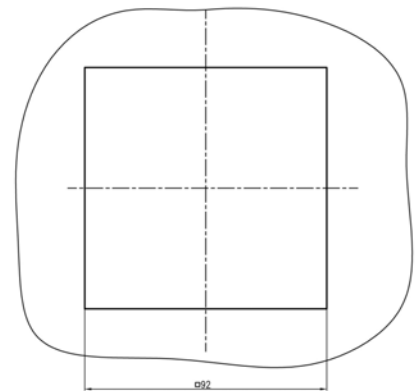
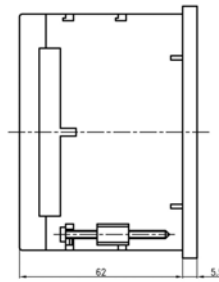
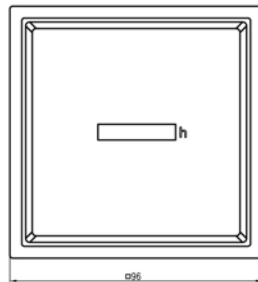

HK 49

Panel cut-out

